

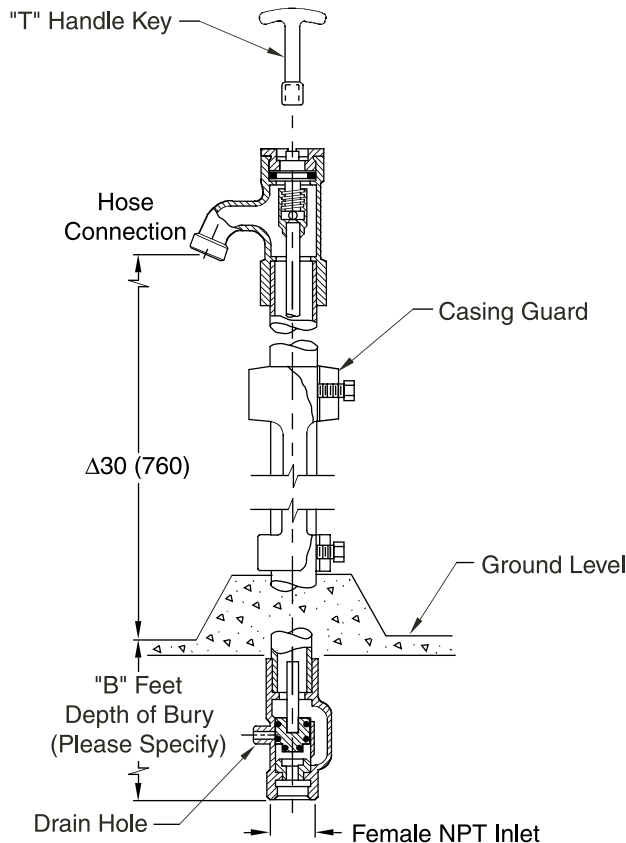

HYDRANTS

NON-FREEZE POST HYDRANT POST HYDRANTS WITH 3/4" (19) OR 1" (25) CONNECTIONS

FUNCTION: Used where an above ground water outlet is required in areas which are subject to freezing temperatures. Freezing is prevented by burying the valve housing below the frost line and draining water from the casing after shut-off.



B (Depth of Bury) = 02(610), 03(915), 04(1220), 05(1525), 06(1830), 07(2135) or 08(2438) Feet

ΔRegularly Furnished (unless otherwise specified)

- NOTES:**
1. All hydrants are manufactured with "NO-LEAD" brazing rings and USDA approved lubricants.
 - *2. Addition of vacuum breaker will not allow draining of the casing. Not responsible for any casings that burst or related incidents if the hydrant is supplied with a vacuum breaker.
 3. The AB1953, California Lead Law, and NSF/ANSI Standard 61-2008 - Drinking Water System Components are not applicable to hydrants as they do not convey/dispense water for human consumption through drinking or cooking.
 4. Dimensions shown in parentheses are in millimeters.
 5. FOR IRRIGATION PURPOSES ONLY.

REGULARLY FURNISHED:

Bronze Non-Freeze Post Hydrant with Cast Iron Casing Guard, and "T" Handle Key. Inlet and Hose Connection Size Furnished as Indicated by Figure Number Selected.

VARIATIONS:

- 1" (25) Hose Connection Adapter -HC1
- 1/8" (3) NPT Drain Hole -NV
- Secured Wheel Handle -WH
- * 3/4" (19) Vacuum Breaker -H (FIG. M-3910 Only)

OPTIONAL MATERIALS:

- Aluminum Casing Guard -AG

- FIG. M-3910 . . . 3/4" (19) } Inlet and Hose Conn.
- FIG. M-3910 . . . 1" (25) }

TECHNICAL DATA

Non-Freeze Post Hydrants are supplied with a special valve housing which prevents freezing of hydrant during non-use periods. The valve housing must be installed below the frost line which prevails for the area of installation. The valve housing has a drain hole which drains the casing when the hydrant is shut off. In effect, there is no water in the casing during non-use periods. Since water from the drain hole is normally allowed to drain into the ground, the valve housing should be set in a bed of gravel. Water drained from the casing can then seep into the ground.

Some locations which require Non-Freeze Post Hydrants cannot tolerate water draining from the drain hole. Examples are parking garages, plazas and roof decks used for recreational purposes. Often in these types of applications the valve housing will protrude into a finished area which is not subject to freezing temperatures. To eliminate the problem of water drainage in this type of installation, can supply a tapped drain hole in the valve housing. Through this tapped drain hole, the water from the valve housing can be piped to a suitable drain.

WARNING: Cancer and Reproductive Harm - www.P65Warnings.ca.gov



HYDRANTS

Hydrant Part List

NON-FREEZE
POST HYDRANT

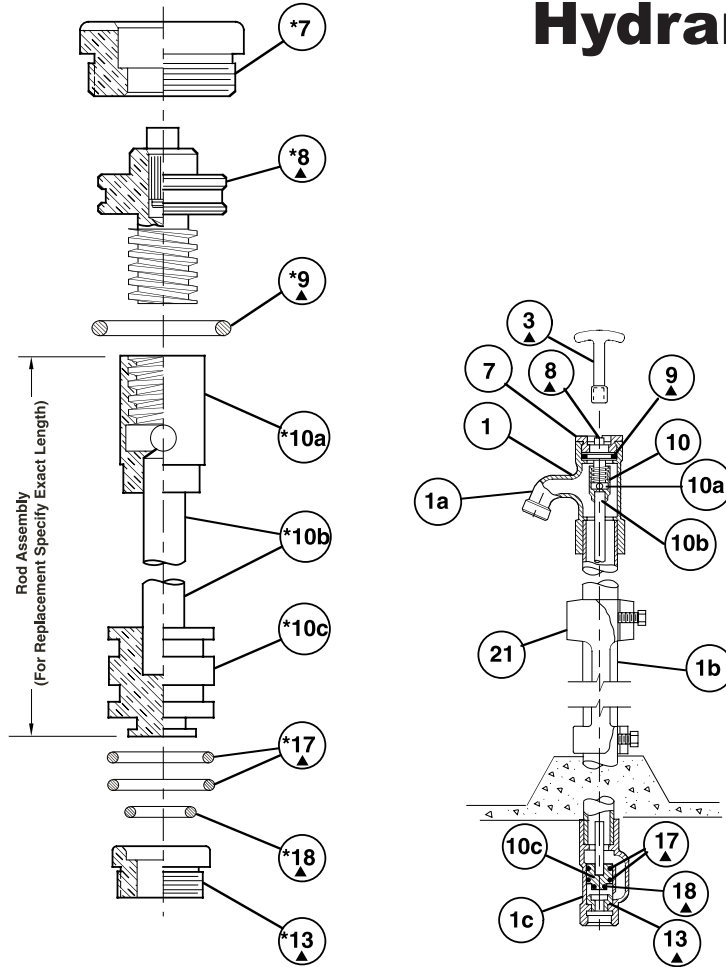

*These parts are accessible from face of hydrant by removing face nut.

▲These replacement parts available in HPRK-41

MAINTENANCE INSTRUCTIONS

1. Shut off water supply.
2. Remove face nut.
3. Pull stem out for complete access to all working parts.
4. Check all working parts for replacement.
5. Replace complete stem assembly and face nut.

REPLACEMENT PARTS LIST-SPECIFY FIGURE NO. WHEN ORDERING			
No.	DESCRIPTION	No.	DESCRIPTION
1	Head/Casing Assembly	10	Operating Rod Assembly
1a	Head	10a	Coupling
1b	Casing	10b	Rod
1c	Valve Housing	10c	Plunger
3	Key	13	Removable Seat
7	Face Nut	17	Plunger "O" Ring
8	Operating Screw	18	Plunger "O" Ring
9	Operating Screw "O" Ring	21	Casing Guard

Murdock Mfg.™ warrants that its products are free from defects in material or workmanship under normal use and service for a period of one year from date of shipment. Murdock's liability under this warranty shall be discharged solely by replacement or repair of defective material, provided Murdock™ is notified in writing within one year from date of shipment, F.O.B. Industry, California.

SELECTION SUMMARY & APPROVAL FOR MANUFACTURING	Model Number & Options _____	Quantity _____	All dimensions are subject to manufactures tolerance of plus or minus 1/2" nominal and subject to change without notice. Murdock assumes no responsibility for use of void or superseded data. Dimensions may change with the addition of optional accessories. Murdock Mfg.™, Member of Morris Group International™. Please visit www.murdockmfg.com for most current specifications.
	Company _____		
	Contact _____	Title _____	
	Signature (Approval for Manufacturing) _____	Date _____	

MURDOCK MFG. • 15125 Proctor Avenue • City of Industry, CA 91746 USA
Phone 800-453-7465 or 626-333-2543 • Fax 626-855-4860 • www.murdockmfg.com

Member of
MORRIS GROUP
INTERNATIONAL